

**MOUNTGRANGE**  
HERITAGE



## Northbow Lodge, GL7

£6,000 per week Fees May Apply

This luxury rental is a spacious 3 bedroom 2800sq ft South facing lakeside property situated in the heart of the Cotswolds with uninterrupted views over a large established lake and close to the pretty Cotswold towns of Cirencester and Fairford. Surrounded by established woodland, all rooms share views of the lake.

**3 Bedrooms | 2 Reception Rooms | 3 Bathrooms**  
**Furnished**

### Notting Hill Office

27 Kensington Park Road, London W11 2EU  
020 7221 2277

[lettings.nhg@mountgrangeheritage.co.uk](mailto:lettings.nhg@mountgrangeheritage.co.uk)

**Other offices** Kensington - North Kensington

[mountgrangeheritage.co.uk](http://mountgrangeheritage.co.uk)

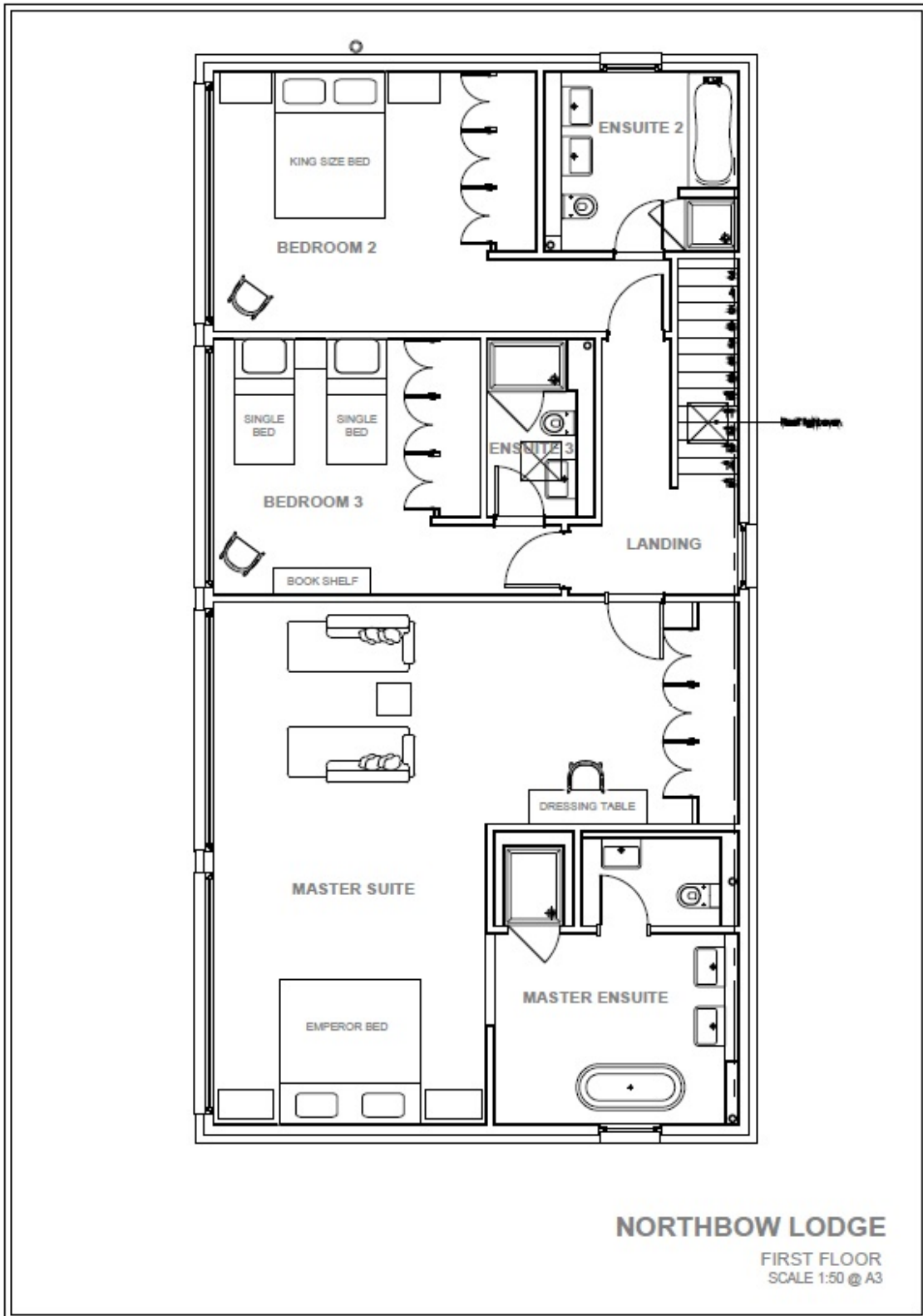

### IMPORTANT NOTICE

Mountgrange Heritage and their clients give notice that: 1) They are not authorised to make or give any representations or warranties in relation to the property either here or elsewhere, either on their own behalf or on behalf of their client or otherwise. They assume no responsibility for any statement that may be made in these particulars. These particulars do not form part of any offer or contract and must not be relied upon as statements or representations of fact. 2) Any areas, measurements or distances are approximate. The text, photographs and plans are for guidance only and are not necessarily comprehensive. It should not be assumed that the property has all necessary planning, building regulation or other consents and Mountgrange Heritage have not tested any services, equipment or facilities. Purchasers must satisfy themselves by inspection or otherwise.